

1

Base Kits have two (2), three (3), or (4) Bases. Align base as referenced in (Figure A).

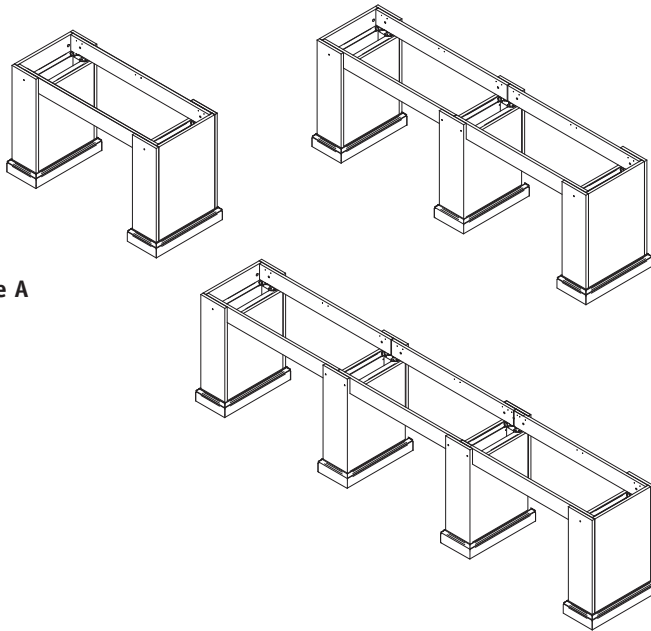

Figure A

2

Align Apron rails with the Silver side facing toward the outside. The raw edge should face up, the worksurface sits on the raw edge. Insert a 1/4"-20 ganging bolt in each Prebored hole, tighten with a Allen wrench. Attach each 3" L Bracket per Base Kit with #8 x 5/8" Pan Head Phillips screw in the Pilot holes (Figure B).

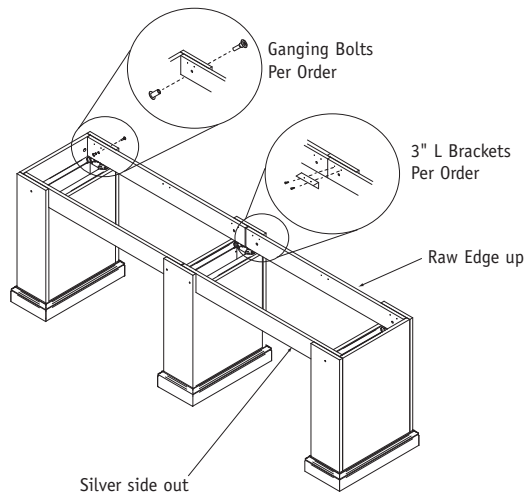

Figure B

Conference and Training Solutions Base Kits

Recommended Tools

- Allen Wrench
- Tape Measure or Ruler
- Phillips Head Screw Driver

Package Contents	Qty.
• #8 x 5/8" Panhead Screws	Per Order
• #8 x 3/4" Panhead Screws	Per Order
• 1/4"-20 Ganging Bolts	Per Order
• 3" L Brackets	Per Order

NATIONAL | Furniture with Personality™

Telephone 800.482.1717
 Fax 812.482.8800
www.NationalOfficeFurniture.com

Part #2143310
 Rev,-

Printed in U.S.A
 © 2010 Kimball International, Inc.

Proper product installation, in accordance with these instructions, is the responsibility of the installing agent. If you have any questions concerning these instructions, please call National Customer Service.

Assembly Instructions

Base Kits

- 3 Align the worksurface by centering it on top of the base kit. Attach with #8 x 5/8" Pan Head screws through the L-Brackets (Figure C).

Figure C

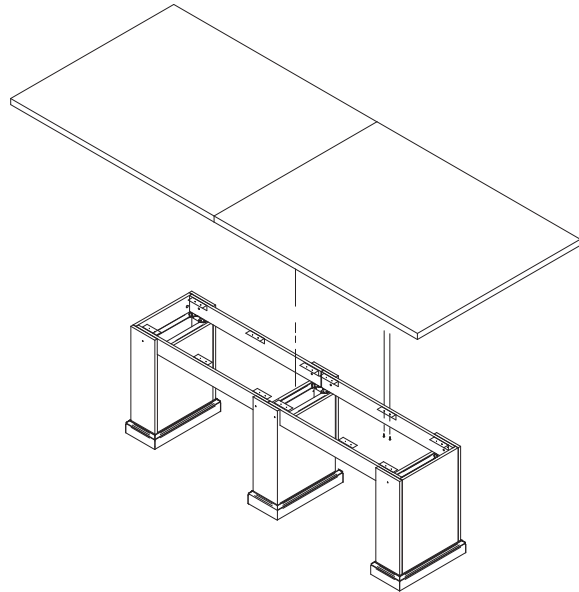

- 4 To remove the access panel, first remove the shipping screw, with a phillips head screw driver. Then grasp at the top and pull (Figure D).

Figure D

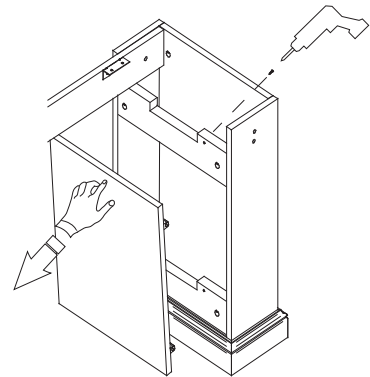

NOTE: Bases could look different.

- 5 To re-install access panel, align the treelok fasteners on the access panel to the receptacles on the wood support rails. Push in to engage (Figure E).

Figure E

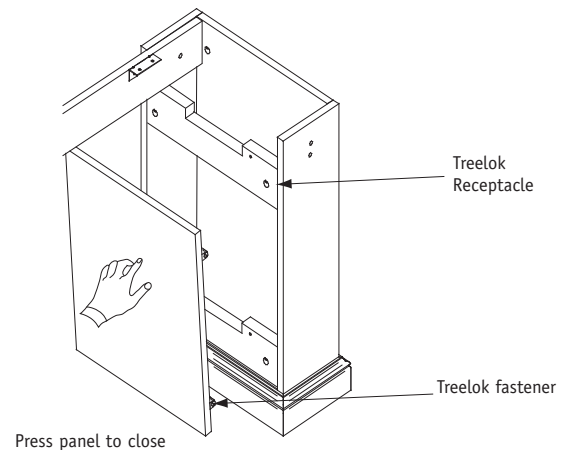

NOTE: Install all electrical wiring. Ensure all conduct and wiring are securely tethered using zip-ties or other fasteners to prevent them from applying force to the back side of the doors