

**ESCALADE SERIES
Highback Organizer
(Full Back)**

1

The highback organizer sits on top of a worksurface. It can be attached to the worksurface using the double faced tape provided.

2

Attach double faced tape to the bottom of the highback organizer's end panels (Figure A).

Figure A

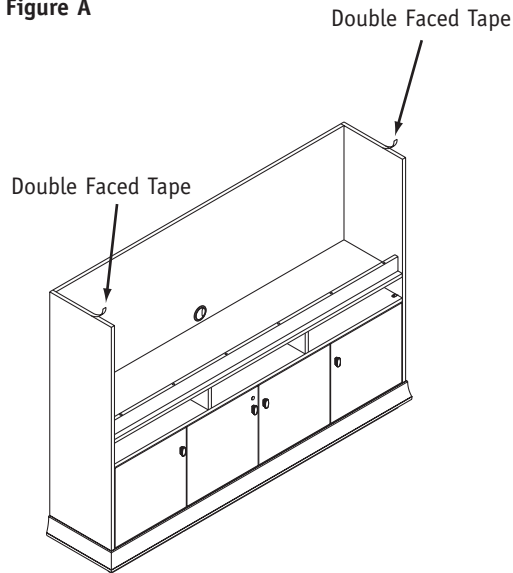

3

Position the highback organizer on top of the worksurface and mark its location. The unit should be positioned flush with the back and $\frac{3}{4}$ " from the side edges of the worksurface. Remove the film backers from the tape. The worksurface must be clean, dry and free from dirt or film to assure adequate adhesion (Figure B).

Figure B

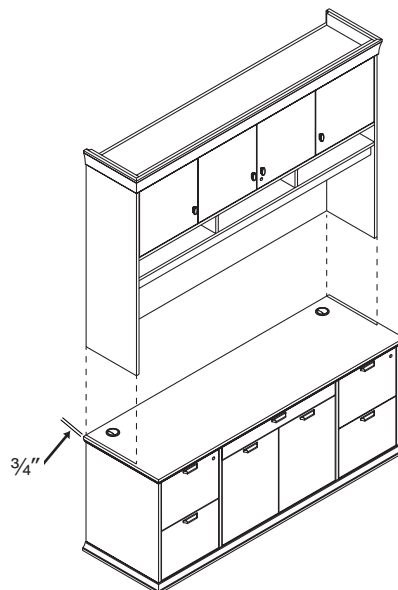

Note: The tape is a very strong adhesive and bonds instantly to the surface it is applied to.

Package Contents	Qty.
• Highback Organizer	1
• Double Faced Tape	

NATIONAL
Furniture with Personality™

Telephone 800.482.1717
Fax 812.482.8800
www.nationalonline.com

Form #NAIEHO
Part #1560993

Printed in U.S.A.
© 2001 Kimball International, Inc.

Proper product installation, in accordance with these instructions, is the responsibility of the installing agent. If you have any questions concerning these instructions, please call National Customer Service.