

ASSEMBLY INSTRUCTIONS

1

Cornice tops can be added to the top of a storage unit. Longer tops can be used to span multiple storage units. All Cornice tops are equipped with spacer rails and foam tape to create a 1/8" reveal line between the storage unit and top (Figure A).

2

Cornice tops (30" to 72" wide) are shipped with two attached spacers. Longer Cornice tops (78" to 108" wide) are shipped with two loose extra spacers. These spacers can be positioned underneath the Cornice top to help support the weight of the Cornice top. Peel off the double stick tape and position as needed.

Note: Spacer needs to be attached to Cornice top, not end panels (Figure A).

3

To attach top to cabinets, measure inside the cabinet 3" from sides. Bore through the inside of the top panel using 3/16" drill bit. Attach Cornice top using 1 1/2" panhead screws (Figure A).

4

Butting two (2) Cornice tops will cause a gap between the storage units below approximately 5/32" (Figure B). Foam tape is provided with each Cornice top to help conceal this gap.

Note: Foam tape is applied to side of one storage unit 1/8" back from edge of the end panel.

Figure A

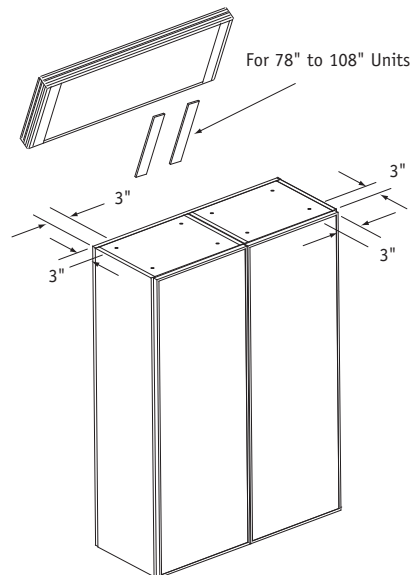
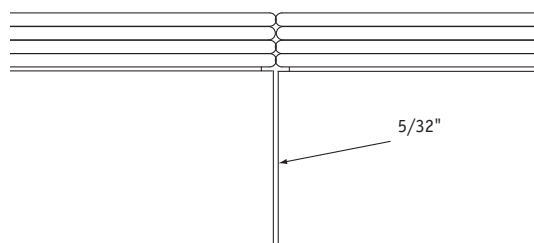

Figure B



WaveWorks® Cornice Tops

Recommended Tools

- Phillips Screwdriver
- Tape measure
- Drill
- 3/16" Drill Bit

Package Contents	Qty.
------------------	------

- | | |
|-----------------------------|---|
| • #8 x 1 1/2" Panhead Screw | 8 |
|-----------------------------|---|

NATIONAL

Furniture with Personality®

Telephone 800.482.1717

Fax 812.482.8800

www.nationalonline.com

Part #2076619

Printed in U.S.A

© 2008 Kimball International, Inc.

Proper product installation, in accordance with these instructions, is the responsibility of the installing agent. If you have any questions concerning these instructions, please call National Customer Service.